

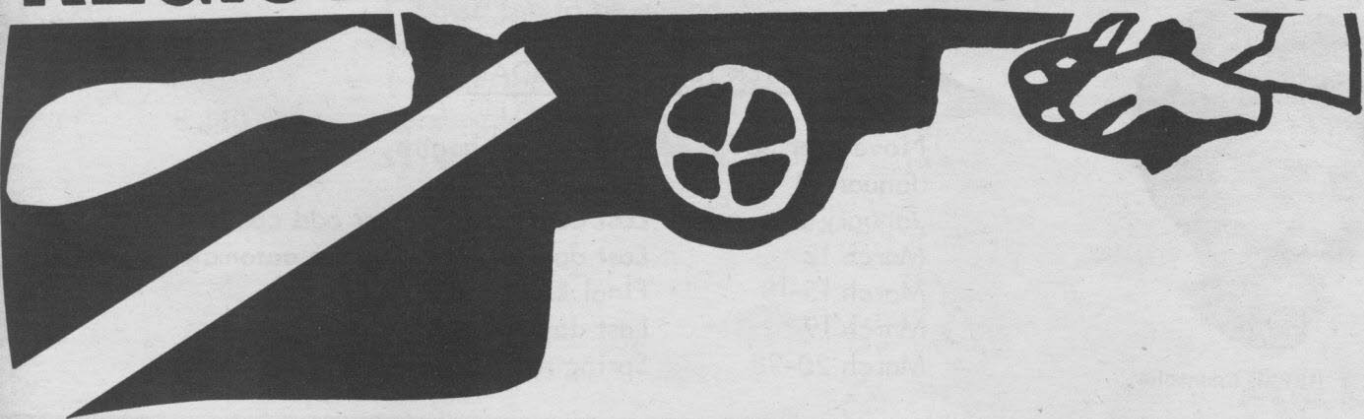

**REGISTER NOW! 926-6091**



# **Linn-Benton Community College**

**CLASS SCHEDULE  
WINTER TERM 1971**



ALBANY, OREGON 97321

## Who's who in student services



LEE ARCHIBALD, Dean Student Personnel Services.

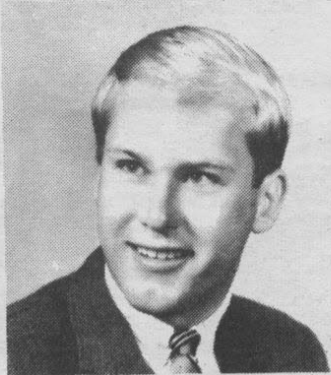

BOB MILLER, Director Student Activities and Student Employment Office, Student Center.



ROBERT TALBOTT, Director Counseling Services.



JANET BREM, Counselor.



RAY MILLER, Counselor.



BLAIR OSTERLUND, Counselor.

**CAMPUS MAP** ↑  
N

# Welcome all!

### WINTER TERM CALENDAR

November 30	Registration begins.
January 4	Classes begin.
January 8	Last day to register or add courses.
March 12	Last day to drop with the automatic "W".
March 15-18	Final Exams.
March 19	Last day of winter quarter.
March 20-28	Spring recess.

Locations other than LBCC campus			
ABC	Albany Boys' Club	1215 S. Hill Street	Albany
AFS	Albany Fire Station	110 E. Sixth Avenue	Albany
AGH	Albany General Hospital	1046 W. Sixth Avenue	Albany
ATB	Auto Technology Building	Second and Oak	Lebanon
CFS	Corvallis Fire Station	465 N.W. Van Buren	Corvallis
CHS	Corvallis High School	836 N.W. Eleventh	Corvallis
LL	Lakeshore Lanes, Inc.	682 Airport Road	Albany
LUHS/AS	Lebanon Union High School -- Ag Shop	South Fifth	Lebanon
Npt HS	Newport High School	322 N.E. Eads	Newport
OSU/IB	Oregon State University	Industrial Building	Corvallis
OSU/PTB	Oregon State University	Production Technology Building	Corvallis
TBA	To be arranged		
WTB	Welding Technology Bldg.	130 Montgomery	Albany
YMCA	Mid-Willamette Family YMCA	3311 S. Pacific Blvd.	Albany
CWC	Corvallis Women's Club	117 NW 7th	Corvallis

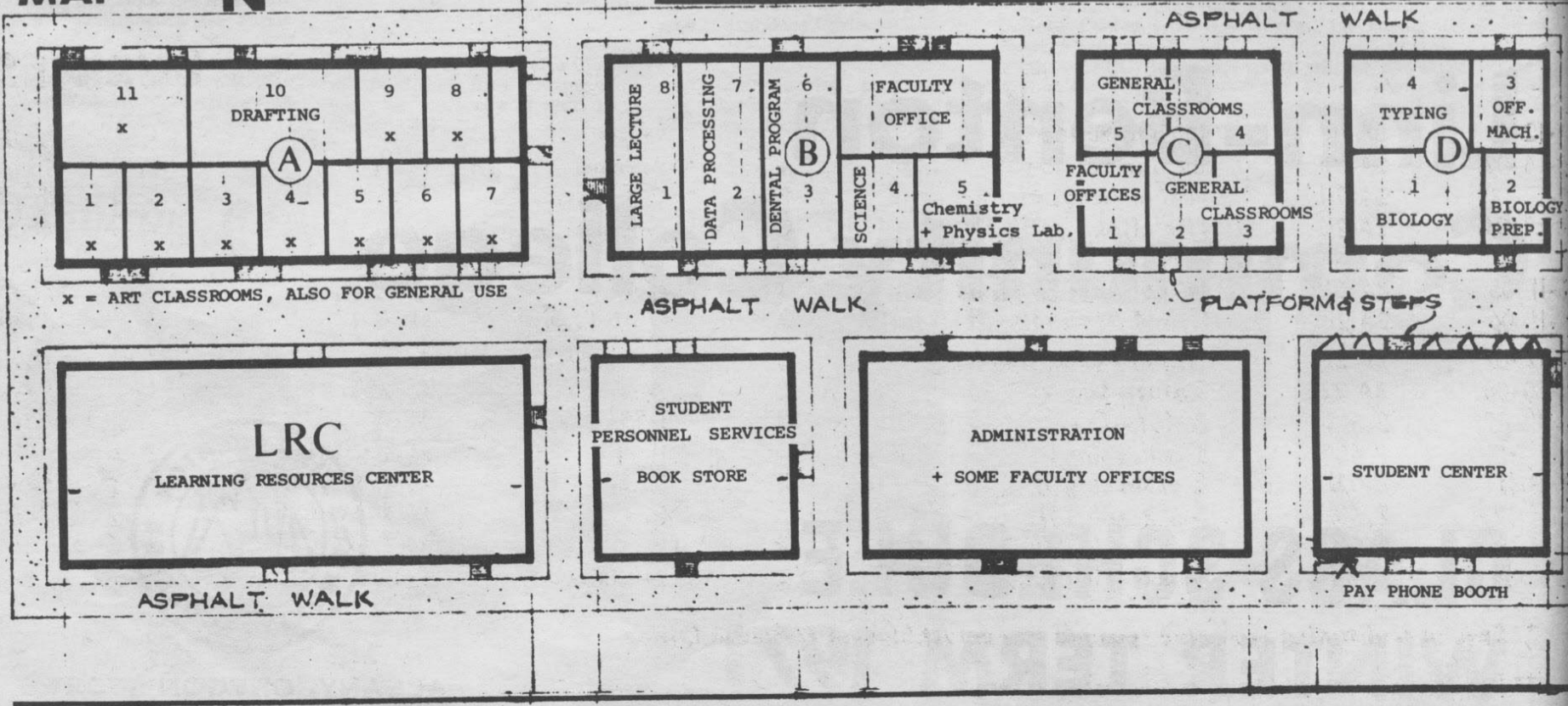

# CLASS SCHEDULE

<u>DE NO.</u>	<u>COURSE NO.</u>	<u>COURSE NAME</u>	<u>CR.</u>	<u>TIME</u>	<u>DAYS</u>	<u>LOCATION</u>	<u>INSTRUCTOR</u>
00-18-01	8.138	Irrig. & Drainage	3	7-10pm	W	C-4	Reid
00-11-02	8.130	Ag. Chem	4	10-12noon	M	B-10	Scott
				12-1pm	Th	C-4	Scott
				1-3pm	F	B-10	Scott
00-12-03	8.126	Soils II	3	9am	T	C-4	Dannan
				8-10am	Th	C-4	Dannan
00-15-04	8.188	Ag. Equip (3 hour lab to be arrang.)	2	3pm	F	C-4	Ritemire
00-12-05	8.135	Turf Manag. (3 hour lab to be arrang.)	2	5pm	T	C-4	Staff
00-13-06	8.140	Landscape Management (3 hour lab to be arrang.)	2	5pm	W	C-4	Staff

## AGRICULTURE

## ALLIED HEALTH

Nursing Assistant (5.406 and 5.407 must be taken concurrently)

20-21-01	5.406*	Nursing Asst. Lecture	5	8:45-9:45am.	M-T-W-Th-F	AGH	Mills
20-21-02	5.407*	Nursing Asst. Lab	7	9:45-2:45pm.	M-T-W-Th-F	AGH	Mills

Dental Assistant (Also take Communication Skills II and Introduction to Psychology and Human Relations)

20-12-03	5.452	Dental Sciences II	3	8-10am	T-Th	B-3	Burton & Goger
20-11-04	5.485	Dental Materials II	1	9-11am	M	B-3	Rohrbough
20-13-05	5.491	Office Management I	2	9-11am	W-F	B-3	Collins
20-11-06	5.472	Laboratory Procedures II	3	1-4pm	M-W-F	B-8	Collins
20-12-07	5.494	Clinical Practice I	3	1-3pm	T-Th	B-3	Collins
20-12-08	5.462	Roentgenology II	1	3pm	T-Th	B-3	Collins

Associate Degree Nursing (\*\* Nursing Students must also take Psy 202 and Anat & Physiology II)

20-11-09	*5.711	Nursing Fund. I Lec.	5	9-11am	M		
				2-3pm	T	NB	Staff
		Nursing Fund. I Lab		8-11am	T-W	NE	Staff
20-13-10	*5.712	Nursing Fund. II Lec.	5	2-3pm	W-Th-F	NB	Staff
		Nursing Fund. II Lab.		8-11am	Th-F	NB	Staff

## BUSINESS

05-12-01	BA 101	Intro to Business	4	1-3pm	T-Th	C-4	Schultz
05-16-02	BA 101	Intro to Business	4	7-9pm	M-W	A-5	Birch
05-12-03	BA 211	Prin of Accounting I	3	3-4:30pm	T-Th	A-3	Chambers
05-13-04	BA 211	Prin of Accounting I	3	7-10pm	W	A-3	Schultz/ Chambers
05-11-05	BA 212	Prin of Accounting II	3	8am	M-W-F	A-7	Schultz
05-11-06	BA 212	Prin of Accounting II	3	12:45-1:35pm	M-W-F	A-7	Schultz
*05-17-07	BA 212	Prin of Accounting II	3	6-7:30pm	T-Th	A-7	Schultz
05-10-08	BA 226	Business Law	3	8am	M-W-F	B-5	Gordon
05-12-09	2.518	Business Law	3	1:30-3pm	T-Th	A-2	Walczak
05-11-10	2.530	Bookkeeping I	3	11am	M-T-W-Th-F	A-3	Brooks
*05-11-11	2.531	Bookkeeping II	3	10am	M-T-W-Th-F	A-3	Brooks
*05-11-12	2.531	Bookkeeping II	3	1pm	M-T-W-Th-F	A-3	Chambers
*05-11-13	2.531	Bookkeeping II	3	2pm	M-T-W-Th-F	A-3	Chambers
*05-17-14	2.531	Bookkeeping II	3	7-9:30pm	T-Th	A-3	Chambers

\* Special registration procedure required -- contact Student Personnel Office

\*\* Requires a prerequisite or consent of instructor

Business, Continued...

CODE NO.	COURSE NO.	COURSE NAME	CR.	TIME	DAYS	LOCATION	INSTRUCTOR
05-11-15	2.515	Business Math	3	9am	M-W-F	A-3	Brooks
05-12-16	1.121	Poise, Posture, & Personality	2	1-2:30pm	T-Th	C-2	Rogers
05-12-17	0.660	Personal Finance	3	3-4:30pm	T-Th	C-2	Rogers
05-11-18	2.536	Analysis of Financial Statements	3	11am	M-W-F	A-2	Schultz
05-11-19	2.516	Intro to Business Statistics	3	10am	M-W-F	A-2	Chambers
05-12-20	2.131	Elements of Marketing	3	12noon-1:30pm	T-Th	A-2	Brooks
05-11-21	SSI21	Typing I	2	3pm	M-T-W-Th-F	D-4	Walczak
	2.501						
*05-11-22	SSI22	Typing II	2	8am	M-T-W-Th-F	D-4	Walczak
	2.502						
*05-11-23	SSI22	Typing II	2	9am	M-T-W-Th-F	D-4	Walczak
	2.502						
*05-11-24	SSI22	Typing II	2	11am	M-T-W-Th-F	D-4	Hazel
	2.502						
*05-11-25	SSI22	Typing II	2	2pm	M-T-W-Th-F	D-4	Hazel
	2.502						
*05-11-26	SSI24	Typing Skill Building	2	10am	M-T-W-Th	D-4	Walczak
	2.504						
*05-57-27	SSI24	Typing Skill Building	2	7-9pm	T-Th	C.H.S.	Williams
	2.504						
05-11-28	SSIII-	Steno I (Gregg)	3	10am	M-T-W-Th-F	D-3	Chester
	2.541						
*05-11-29	SSII2	Steno II (Gregg)	3	1pm	M-T-W-Th-F	D-4	Hazel
	2.542						
*05-16-30	SSIII-112-113-2	.541-2.542-2.543 Steno I, II, III (Gregg)	3	7-9:30pm	M-W	D-4	Hazel
** 05-17-31	SS212-2.542	Applied Steno II (Gregg & Machine)	3	7-10pm	T-Th	D-4	Hazel
05-11-32	2.548	Business English	3	12noon	M-W-F	D-4	Chester
05-11-33	2.521	Office Machines	3	1pm	M-T-W-Th-F	D-3	Chester
*05-11-34	2.522	Advanced Office Machines	3	9am	M-T-W-Th-F	D-3	Chester
*05-20-36	2.711	On-Job-Training (Management)	4	Arranged by instructor			Brooks
*05-20-37	2.614	On-Job-Training (Secretarial)	4	Arranged by instructor			Brooks
05-18-38	2.509	Intro to Data Pro	3	7-10pm	W	B-7	Clark
05-12-39	2.509	Intro to Data Pro	3	9:30-11am	T-Th	B-7	Clark
*05-12-40	2.565	Documentation Proced.	3	1-2:30pm	T-Th	B-7	Clark
*05-11-41	2.562	Micro-Language I	3	2pm	M-W-F	B-7	Shelton
*05-16-42	2.570	Macro-Language II	3	7-10pm	M	B-7	Shelton
*05-19-43	2.578	Programming Concepts & Technology	3	7-10pm	Th	B-7	Shelton
** 05-17-44	2.580	Application Programs	3	7-10pm	T	B-7	Hatfield

## CREATIVE ARTS

**10-11-01	Art 196	Basic Design	2	1-3pm+	M	A-1	Mack
**10-16-02	Art 196	Basic Design	2	7-9pm+	M	A-1	Brick
10-11-03	Art 202	Survey of Vis Arts	3	11am	M-W-F	C-4	Brick
10-11-04	Art 202	Survey of Vis Arts	3	2pm	M-W-F	C-4	Brick
10-13-05	Art 235	Jewelry & Metalsmithing	2	1-4pm	W	A-1	Staff
*10-18-06	Art235-6-7	Jewelry & Metalsmithing	2	7-10pm	W	TBA	Staff
*10-66-07	Art 255	Ceramics	2	7-9pm	M	OSU/IB	Wiprud
*10-67-08	Art 255	Ceramics	2	7-9pm	T	OSU/IB	Bowman
10-12-09	Art 290	Painting	2	1-4pm	T-Th	A-11	Brick
10-17-10	Art 290	Painting	2	7-10pm	T-Th	A-11	Brick
10-12-11	Art 291	Drawing	2	9-11am	T-Th	A-11	Mack
10-13-12	Art 291	Drawing	2	1-3pm	W-F	A-11	Mack
10-11-13	Art 292	Water Color	2	3-5pm	M-W	A-11	Mack
10-11-14	9.255	Commercial Art	2	9-11am	M-W	A-1	Mack

+Plus outside assignments

\* Must pre-register

\*\*Requires a prerequisite or consent of instructor

CTOR CODE NO. COURSE NO. COURSE NAME CR. TIME DAYS LOCATION INSTRUCTOR

## ENVIRONMENTAL CONTROL

11-16-01	6.102	Intro to Envir Tech II	3	7-10pm	M	A-2	Suddreth
11-12-02	6.200	Solid Wastes Disposal	3	9:30-11am	T-Th	A-2	Suddreth

## FIRE SCIENCE

12-68-01	5.287	Physics (Fire Science)	3	7-10pm	W	CFS	Staff
12-29-02	5.287	Physics (Fire Science)	3	7-10pm	Th	AFS	Staff

## HEALTH AND PHYSICAL EDUCATION

15-21-01	PE 185	Beginning Bowling	1	3pm	M-W-F	LL	McClain
** 15-22-02	PE 185	Intermed Bowling	1	8-9:30am	T-Th	LL	McClain
** 15-21-03	PE 185	Advanced Bowling	1	8am	M-W-F	LL	McClain
15-21-04	PE 190	Begin Basketball	1	9am	M-W-F	ABC	Kimpton
** 15-21-05	PE 190	Intermed Basketball	1	10am	M-W-F	ABC	Kimpton
* 15-21-06	PE 190	Intermed Basketball	1	1pm	M-W-F	ABC	Kimpton
* 15-22-07	PE 190	Baseball Skills & Conditioning	1	2-3:30pm	T-Th	ABC	McClain
15-22-08	PE 185	Beginning Gymnastics	1	9:30-11am	T-Th	ABC	Crosman
** 15-22-08	PE 185	Intermediate Gymnastics	1	9:30-11am	T-Th	ABC	Crosman
15-22-09	PE 180	Body Conditioning	1	8-9:30am	T-Th	ABC	Crosman
15-22-10	PE 190	Handball	1	8-9:30am	T-Th	YMCA	Kimpton
15-22-10	PE 185	Badminton	1	8-9:30am	T-Th	YMCA	Kimpton
15-22-11	PE 190	Weight Training and Conditioning	1	2pm	M-W-F	ABC	Kimpton
15-22-12	PE 185	Beginning Volleyball	1	9:30-11	T-Th	YMCA	Kimpton
** 15-22-12	PE 185	Intermed Volleyball	1	9:30-11	T-Th	YMCA	Kimpton
** 15-21-13	PE 190	Intermed Volleyball	1	8am	M-W-F	ABC	Kimpton
15-21-14	PE 190	Wrestling	1	11am	M-W-F	ABC	McClain
15-21-15	PE 185	Beginning Swimming	1	11am	M-W-F	YMCA	Crosman
** 15-21-16	PE 185	Intermed Swimming	1	10am	M-W-F	YMCA	Crosman
15-66-17	PE 180	Ballet	1	7-8:30pm	M-Th	CWC	Irwin
15-13-18	HE 250	Personal Health	2	8am	W-F	B-6	Crosman
15-13-19	HE 250	Personal Health	2	9am	W-F	B-6	Crosman
15-12-20	HE 250	Personal Health	2	1pm	T-Th	B-6	Crosman

## INDUSTRIAL

** 30-71-01	3.280	Transmissions II	3	2-5pm 10:30am-1:30pm	M F	ATB	Pond
** 30-72-02	3.292	Chassis II	3	2-5pm	T-Th	ATB	Carter
30-73-03	3.329	Auto Repair Prac	3	1:30-5pm	W-F	ATB	Carter/ Hoswor
30-71-04	3.335	Auto Electricity	6	8-10:30am	M-T-W-Th	ATB	Carter
30-71-05	3.335	Auto Electricity	6	10:30am-1pm	M-T-W-Th	ATB	Pond/ Hoswor
30-71-06	3.364	Fuels & Carb	3	10:30 am-1pm	M-W	ATB	Pond
30-72-07	3.364	Fuels & Carb	3	8-10:30am	T-W	ATB	Pond
** 30-67-08	3.381	Machine Tools II	2	6:30-10:30pm	T	OSU/ PTB	Sawyer
** 30-68-09	3.384	Machine Tools V	2	6:30-10:30pm	W	OSU/ PTB	Sawyer
30-17-10	4.101	Draft & Blueprint I	2	7-9pm	T-Th	A-10	Reynolds
** 30-11-11	4.111	Drafting II	3	1pm	M	A-10	Spurr

\* Requires consent of instructor

\*\* Requires a prerequisite or consent of instructor

Industrial, Continued . . .

CODE NO.	COURSE NO.	COURSE NAME	CR.	TIME	DAYS	LOCATION	INSTRUCTOR
** 30-11-12	4.114	Architectural Draft	4	8-11am		T-Th	A-10 Spurr
** 30-12-13	4.115	Presentation Drawing	2	8am-12noon		M-W	A-10 Reynolds
** 30-13-14	4.116	Architect Planning	4	2-4pm		T-Th	A-10 Reynolds
** 30-12-15	4.120	Fund Specifications	3	1-5pm		W-F	A-10 Reynolds
30-12-16	4.128	Drafting Practices	2	11am		T-Th-F	A-10 Spurr
30-28-17	4.151	Welding I	2	1pm		T-Th-F	A-10 Spurr
** 30-26-18	4.152	Welding II	2	6-10pm		M	WTB Stewart
** 30-22-19	4.152	Welding II	2	3-4:30pm		M-W	WTB Love
** 30-24-20	4.152	Welding II	2	3pm		F	WTB Love
** 30-26-21	4.152	Welding II	2	3-6pm		T	WTB Love
** 30-77-22	4.152	Welding II	2	3pm		F	WTB Love
** 30-21-23	4.241	Intermediate Arc Weld	6	2-5pm		Th	WTB Love
** 30-21-24	4.241	Intermediate Arc Weld	6	3pm		F	WTB Love
** 30-21-25	4.243	Intermediate Oxy Weld	4	6-10pm		W	WTB Love
30-21-26	4.243	Intermediate Oxy Weld	4	6-10pm		T	LUHS/ Miller
30-22-27	4.245	Layout Procedures for Welding	3	9am-12noon		M-T-W-Th	AS
30-27-28	9.148	Prep for Cert Weld	3	1-3pm		F	WTB Alvin
30-16-29	6.294	Process Metallurgy	3	1-3pm		F	WTB Alvin
30-18-30	6.288	Vacuum Technology	3	12-3pm		M-T-W-Th	WTB Stewart
				1-3pm		F	WTB Alvin
				9-11am		M-T-W	WTB Stewart
				1-3pm		F	WTB Alvin
				1-3pm		M-T-W-F	WTB Alvin
				8am		T-Th	WTB Love
				9am-12noon		F	WTB Love
				6-10pm		T-Th	WTB Chilstrom
				7-10pm		M	A-3 Gale
				7-10pm		W	C-5 Bird

## LANGUAGE ARTS

35-11-01	WR III	English Composition	3	10am		M-W-F	A-9 Staff
35-11-02	WR III	English Composition	3	2pm		M-W-F	C-2 Call
35-17-03	WR III	English Composition	3	7-10pm		T	C-3 Staff
**35-11-04	WR II2	English Composition	3	8am		M-W-F	C-3 Cheney
**35-11-05	WR II2	English Composition	3	9am		M-W-F	C-2 Williams
**35-12-06	WR II2	English Composition	3	9:30-11am		T-Th	C-5 Williams
**35-11-07	WR II2	English Composition	3	10am		M-W-F	C-3 Bervin
**35-11-08	WR II2	English Composition	3	11am		M-W-F	C-3 Cheney
**35-19-09	WR II2	English Composition	3	7-10pm		Th	C-3 Bervin
**35-11-10	WR II2	English Composition	3	1pm		M-W-F	C-2 Williams
**35-11-11	WR II2	English Composition	3	2pm		M-W-F	C-3 Cheney
**35-11-12	WR II2	English Composition	3	3pm		M-W-F	C-2 Call
**35-6-13	WR II2	English Composition	3	7-10pm		M	Npt Bervin
**35-12-14	WR II3	English Composition	3	9:30-11am		T-Th	HS
**35-11-15	WR II3	English Composition	3	11am		M-W-F	C-2 Call
35-11-16	Eng 102	Survey of English Lit	3	1pm		M-W-F	C-5 Minnick
35-11-17	Eng 105	Intro to Literature	3	9am		M-W-F	C-5 Minnick
35-11-18	Eng 105	Intro to Literature	3	10am		M-W-F	C-5 Minnick
35-11-19	Eng 105	Intro to Literature	3	2pm		M-W-F	C-5 Minnick
35-17-20	Eng 105	Intro to Literature	3	7-10pm		T	C-5 Call
35-19-21	Eng 105	Intro to Literature	3	7-10pm		Th	C-2 Staff
35-18-22	Eng 106	Intro to Literature	3	7-10pm		W	C-3 Cheney
35-12-23	Eng 108	World Literature	3	9:30-11am		T-Th	C-3 Cheney
35-16-24	Eng 108	World Literature	3	7-10pm		M	C-5 Staver
35-11-25	Eng 254	Survey of American Lit	3	10am		M-W-F	C-2 Williams
35-16-26	Eng 115	Effective Reading	3	7-10pm		M	LRC 3 Carlson
35-18-27	Eng 115	Effective Reading	3	7-10pm		W	LRC 3 Nelson
35-16-28	Sp III	Fundamentals of Speech	3	7-10pm		M	B-5 Tokarski
35-11-29	Sp III	Fundamentals of Speech	3	2pm		M-W-F	A-5 George
35-12-30	Sp III	Fundamentals of Speech	3	9:30-11am		T-Th	B-5 Tokarski
35-12-31	Sp III	Fundamentals of Speech	3	1-2:30pm		T-Th	A-5 Tokarski
**35-11-32	Sp II2	Fundamentals of Speech	3	9am		M-W-F	A-5 George
**35-11-33	Sp II2	Fundamentals of Speech	3	10am		M-W-F	A-5 George
**35-11-34	Sp II2	Fundamentals of Speech	3	3pm		M-W-F	A-5 George
**35-11-35	Sp II3	Fundamentals of Speech	3	11am		M-W-F	A-5 Tokarski

\*\* Requires a prerequisite or consent of instructor

CODE NO.	COURSE NO.	COURSE NAME	CR.	TIME	DAYS	LOCATION	INSTRUCTOR
35-12-36	0.655	Basic English	3	8-9:30	T-Th	C-5	Minnick
35-11-37	0.656	Developmental Reading	2	10am	M-W-F	LRC 3	Mann
35-11-38	0.656	Developmental Reading	2	1pm	M-W-F	LRC 3	Mann
35-17-39	0.656	Developmental Reading	2	6:30-8pm	T-Th	LRC 3	Mann
35-11-40	1.101	Communication Skills I	3	9am	M-W-F	C-2	Murray
* 35-11-41	1.104	Communication Skills II	3	8am	M-W-F	B-3	Williams
35-11-42	1.104	Communication Skills II	3	9am	M-W-F	A-2	Bervin
35-11-43	1.104	Communication Skills II	3	2pm	M-W-F	A-2	Murray
35-18-44	1.104	Communication Skills II	3	7-10pm	W	A-2	Staff
35-12-45	9.025	Intro to Journalism and Lab	3	1pm	T-Th-F	BR	Cheney
35-12-46	Sp 250	Speech & Theatre Workshop	1-3	(*)	(*)	(*)	George

## LAW ENFORCEMENT

40-16-01	LE II2	Law Enforcement and Society	3	7-10pm	M	C-2	Molinari
----------	--------	-----------------------------	---	--------	---	-----	----------

## PHILOSOPHY

42-12-01	Phl 202	Elementary Ethics	3	1-2:30pm	T-Th	A-4	Clark, R.
----------	---------	-------------------	---	----------	------	-----	-----------

## SCIENCE AND MATH

* 45-11-01	Bi 102	Biology Lecture	4	8am	M	C-4	Ross
* 45-11-02	Bi 102	Biology Lecture	4	3pm	M	C-4	Ross
* 45-11-03	Bi 102	Biology Lecture	4	4pm	M	C-4	Ross
* 45-16-04	Bi 102	Biology Lecture	4	7pm	M	C-4	Ross
	Bi 102	Biology Learning Activities					
		(Are Scheduled at Students Convenience during These Hours -- 8-10pm M, 9am-10pm T, 9am-5pm W, 9am-1pm Th)					
45-14-05	Bi 102	Biology Discussion Session		1pm	Th	D-1	Staff
45-14-06	Bi 102	Biology Discussion Session		2pm	Th	D-1	Staff
45-19-07	Bi 102	Biology Discussion Session		7pm	Th	D-1	Staff
45-15-08	Bi 102	Biology Discussion Session		8am	F	D-1	Staff
45-15-09	Bi 102	Biology Discussion Session		9am	F	D-1	Staff
45-15-10	Bi 102	Biology Discussion Session		10am	F	D-1	Staff
45-15-11	Bi 102	Biology Discussion Session		11am	F	D-1	Staff
45-15-12	Bi 102	Biology Discussion Session		1pm	F	D-1	Staff
45-15-13	Bi 102	Biology Discussion Session		2pm	F	D-1	Staff
45-15-14	Bi 102	Biology Discussion Session		3pm	F	D-1	Staff
** 45-12-15	5.603	Anat & Physiology II Lecture	3	3-4:30pm	T-Th	C-4	Howell
45-11-16	5.604	Anat & Physiology II Lab		2-4pm	M	D-1	Howell
45-11-17	5.604	Anat & Physiology II Lab		4-6pm	M	D-1	Howell
* 45-12-18	Ch 102	General Chemistry Lecture	3	11am	T-Th	B-9	Staff
45-15-19	Ch 102	Chemistry Recitation		11am	F	B-6	Staff
45-15-20	Ch 102	Chemistry Recitation		12 noon	F	B-6	Staff
45-13-21	Ch 102	General Chemistry Lab		10am-12 noon	W	B-10	Staff
45-13-22	Ch 102	General Chemistry Lab		1-3pm	W	B-10	Staff
* 45-11-23	Ch 105	General Chemistry Lecture	5	8am	M-W-Th-F	B-9	Scott
* 45-11-24	Ch 105	General Chemistry Lec	5	3pm	M-W-Th-F	B-9	Scott
45-12-25	Ch 105	General Chemistry Lab		8-11am	T	B-10	Staff
45-12-26	Ch 105	General Chemistry Lab		11am-2pm	T	B-10	Staff
45-12-27	Ch 105	General Chemistry Lab		2-5pm	T	B-10	Scott
* 45-17-28	G 202 & G205	Geology Lect & Lab	4	7-10pm	T	B-9&	White
				7-9pm	Th	B-10	White
* 45-11-29	GS 105	Physical Science Lec	4	2pm	M-W-F	B-9	Perkins
		Physical Science Lab		10am-12noon	Th	B-10	Perkins
* 45-16-30	GS 105	Physical Science Lec - Lab	4	7-10pm	M	B-9&	Perkins
				7-9pm	W	B-10	Perkins
* 45-11-31	Ph 201	General Physics Lec	4	12:15-2pm	M-F	B9&10	Cooper
		General Physics Lab		1pm	W	B-9	Cooper
* 45-11-32	4.300	Practical Physics Lec	4	10am-12noon	M-W	B-9	Perkins
45-15-33	4.300	Practical Physics Lab (Auto)		8-10am	F	B-10	Perkins
45-15-34	4.300	Practical Physics Lab (Drafting)		10am-12noon	F	B-10	Perkins
45-11-35	1.110	Elements of Algebra	3	9am	M-T-W-F	A-7	Abbas
45-11-36	1.110	Elements of Algebra	3	11am	M-T-W-F	A-7	Abbas
45-11-37	1.110	Elements of Algebra	3	1pm	M-T-W-F	A-6	Wright
45-16-38	1.110	Elements of Algebra	3	7-8:30pm	M-W	A-7	Abbas

\*All science lectures must be taken concurrently with learning activities, labs, and discussion or recitation sections which are scheduled for a given course.

\*\* Requires a prerequisite or consent of instructor.

(\*) Time and place to be arranged First Meeting Tuesday at 1pm in room C-3

Science and Math Continued...

CODE NO.	COURSE NO.	COURSE NAME	CR.	TIME	DAYS	LOCATION	INSTRUCTOR
45-11-39	Mth 95	Intermediate Algebra	4	10am	M-T-W-F	A-6	Wright
45-11-40	Mth 95	Intermediate Algebra	4	2pm	M-T-W-F	A-6	Wright
45-17-41	Mth 95	Intermediate Algebra	4	7-9pm	T-Th	A-6	Staff
** 45-11-42	Mth 101	College Algebra	4	10am	M-T-W-F	A-7	Nielsen
** 45-11-43	Mth 101	College Algebra	4	2pm	M-T-W-F	A-7	Nielsen
** 45-17-44	Mth 101	College Algebra	4	7:30-9:30pm	T-Th	A-7	Atwood
** 45-11-45	Mth 102	Trigonometry	4	10am	M-T-W-F	A-8	Siebler
** 45-11-46	Mth 102	Trigonometry	4	2pm	M-T-W-F	A-8	Siebler
** 45-16-47	Mth 102	Trigonometry	4	7-9pm	M-W	A-8	Rasmussen
** 45-11-48	Mth 192	Math for Elementry Teachers	4	11am	M-T-W-F	A-6	Nielsen
** 45-11-49	Mth 200	Calculus	4	9am	M-T-W-F	A-6	Wright
** 45-11-50	Mth 201	Calculus	4	11am	M-T-W-F	A-8	Siebler
** 45-17-51	Mth 201	Calculus	4	7-9pm	M-T-W-F	A-8	Siebler
45-18-52	0.668	Basic Math I	3	7-10pm	T-Th	B-5	Staff
** 45-11-53	0.669	Basic Math II	3	3pm	W	A-7	Staff
45-11-54	4.145	Industrial Math I	3	1pm	M-W-F	A-8	Nielsen
45-18-55	4.145	Industrial Math I	3	7-10pm	M-W-F	A-6	Swearengen
** 45-11-56	4.146	Industrial Math II	3	8am	W	A-8	Nielsen
45-10-57	6.337	Slide Rule	1	8am	M-W-F	LRC-4	Perkins
					Arranged by Inst.		

## SOCIAL SCIENCE

50-18-01	Anth 102	General Anthropology	3	7-10pm	W	C-2	Saunders
50-16-02	Anth 208	Cultural Anthropology	3	7-10pm	M	A-4	Klein
** 50-17-03	Ec 202	Prin of Economics	3	7-10pm	T	B-6	Tamler
** 50-19-04	Ec 202	Prin of Economics	3	7-10pm	Th	B-6	Moghaddam
50-16-05	Geog 106	Introductory Geography	3	7-10pm	M	B-6	Britton
50-11-06	Geog 106	Introductory Geography	3	1pm	M-W-F	B-6	Britton
50-11-07	Hst 102	History of Western Civ	3	9am	M-W-F	C-4	Barnes
50-11-08	Hst 102	History of Western Civ	3	10am	M-W-F	C-4	Barnes
50-11-09	Hst 102	Histry of Western Civ	3	1pm	M-W-F	C-4	Barnes
50-12-10	Hst 102	History of Western Civ	3	9:30-11am	T-Th	B-6	Barnes
50-16-11	Hst 102	History of Western Civ	3	7-10pm	M	A-9	Durham
50-11-12	Hst 202	History of U.S.	3	9am	M-W-F	A-9	Durham
50-11-13	Hst 202	History of U.S.	3	11am	M-W-F	A-9	Durham
50-12-14	Hst 202	History of U.S.	3	9:30-11am	T-Th	A-9	Durham
50-13-15	Hst 202	History of U.S	3	7-10pm	W	A-9	Durham
50-11-16	Ps 202	American Governments	3	9am	M-W-F	A-4	Lieberman
50-11-17	Ps 202	American Governments	3	1pm	M-W-F	A-4	Lieberman
50-17-18	Ps 202	American Governments	3	7-10pm	T	A-2	Broadbent
50-12-19	Psy 201	General Psychology	3	8-9:30am	T-th	A-5	Montgomery
50-11-20	Psy 202	General Psychology	3	8am	M-W-F	A-5	Montgomery
50-11-21	Psy 202	General Psychology	3	1pm	M-W-F	A-5	Montgomery
50-17-22	Psy 202	General Psychology	3	7-10pm	T	A-9	Montgomery
50-19-23	Psy 202	General Psychology	3	7-10pm	Th	A-9	Montgomery
50-12-24	Psy III	Personal Development	3	1-3pm	T-Th	A-9	Staff
50-18-25	Soc 204	General Sociology	3	7-10pm	W	A-4	Lieberman
50-11-26	Soc 205	General Sociology	3	10am	M-W-F	A-4	Lieberman
50-12-27	Soc 205	General Sociology	3	9:30-11am	T-Th	A-4	Lieberman
50-11-28	Soc 205	General Sociology	3	2pm	M-W-F	A-4	Lieberman
50-11-29	1.607	Intro to Psychology and Human Relations	3	4pm	M-W-F	A-2	Ackerman
50-12-30	1.124	American Institutions	3	9:30-11am	T-Th	A-5	Staff

## SUPERVISION

55-16-01	9.501	Written Comm. for Supv	3.	7-10pm	M	A-6	Staff
55-17-02	9.509	Industrial Economics	3	7-10pm	T	C-5	Staff
55-18-03	9.516	Supv Responsibility for mgmt. of Personnel	3	7-10pm	W	B-6	Staff
55-19-04	9.502	Basic Psychology for Supervision	3	7-10pm	Th	A-2	Staff

\* All Science lectures must be taken concurrently with learning activities, labs, and discussion or recitation sections which are scheduled for a given course.

\*\* Requires a prerequisite or consent of instructor.